

- **Nitinol Memory Alloy**
- **Reduced Surgery Time**

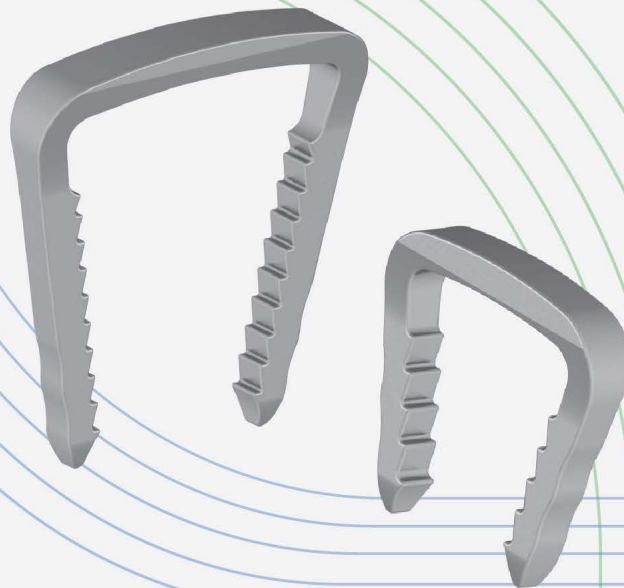

Sawtooth-Arm Embracing Fixator

Elastic Fixation/Continuous Compression/Rapid Healing

Sawtooth-Arm Embracing Fixator



Features:

- **Fracture End Compression:** The serrated arm loop embraces the internal fixation device, which is a Nitinol implant. Its unique shape memory function continuously provides axial self-compression to the fracture end.
- Non-stress shielding, elastic fixation effectively prevents nonunion.
- Utilizing the superelasticity of nickel-titanium alloy, no need for hot or cold water treatment, directly expand and install using matching tools.
- Implants are available in various sizes for different areas.

Indications:

- Fixation of epiphyseal and intra-articular fractures.
- Fixation of various irregular bones and small bone fragments such as pelvis and flat bones.
- Auxiliary fixation of long bone fractures.
- Fractures, osteotomies, and joint fusions in the hands or feet.
- Fixation of ligaments and tendons in sports medicine.
- Relevant applications in neurosurgery, maxillofacial surgery, etc.
- Fixation of micro-motion joints such as the sternoclavicular, acromioclavicular, and sacroiliac joints.

Sawtooth-Arm Embracing Fixator

Sawtooth-Arm Block Hoop Straddle Nail



Product Name	Specification	Product No.	Bridge Length	Leg A Length	Leg B Length	
Sawtooth-Arm Block Hoop Straddle Nail	M15	Extended Type	Q1001510	10	8	8
			Q1001512	12	10	10
			Q1001514	14	10	10
			Q1001516	16	15	15
			Q1001519	19	18	18
			Q1001521	21	20	20
		Standard Type	Q1001526	26	20	20
			Q1001512D	12	6	6
			Q1001514D	14	8	8
			Q1001516D	16	10	10
			Q1001519D	19	12	12
			Q1001521D	21	16	16
			Q1001526D	26	16	16
			Note: Bridge length 10/12/14 use 2.1mm drill bit; Bridge length 16/19/21/26 use 2.8mm drill bit.			

Sawtooth-Arm Block Hoop Embracing Fixtor (Six Teeth)



Product Name	Specification	Apply the outer diameter of fracture (mm)
Sawtooth-Arm Block Hoop Embracing Fixtor (Six Teeth)	Q16	16-20
	Q20	20-24
	Q24	24-26
	Q26	26-29
	Q29	29-33
	Q33	33-37
Caution: Cold Hot Water Treatment required before installation.		

Sawtooth-Arm Block Hoop Embracing Fixtor (Ten Teeth)



Product Name	Specification	Apply the outer diameter of fracture (mm)
Sawtooth-Arm Block Hoop Embracing Fixtor (Ten Teeth)	Q16	16-20
	Q20	20-24
	Q24	24-26
	Q26	26-29
	Q29	29-33
	Q33	33-37
Caution: Cold Hot Water Treatment required before installation.		

Sawtooth-Arm Embracing Fixator

Clinical Cases



Sawtooth-Arm Embracing Fixator

Operation Procedure

M20 Standard BL 14mm for Sample

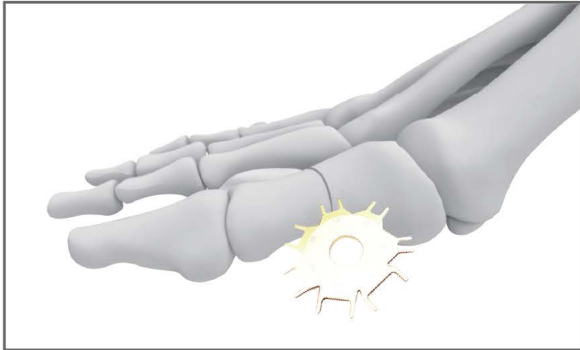

Fig.1

1. Determine size

Use a size wheel to measure the surgical site and determine the size of the required product.



Fig.2

2. Drill

① Use a $\phi 2.1$ drill bit with a stopper sleeve to guide drilling with a guider of corresponding size.

Note: Standard Type: use a matched stopper sleeve when drilling.
Extended Type: DO NOT use the stopper sleeve when drilling.



Fig.3

② Temporarily fix the drilled hole with a positioning rod.



Fig.4

③ Drill on the other side.

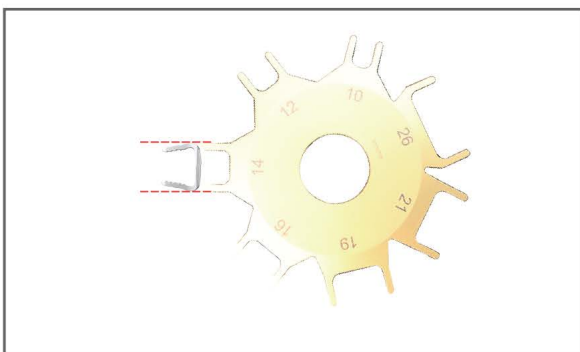

Fig.5

3. Size check

Measure the bridge length marked on the selected product using a size wheel to prevent mis-installation.

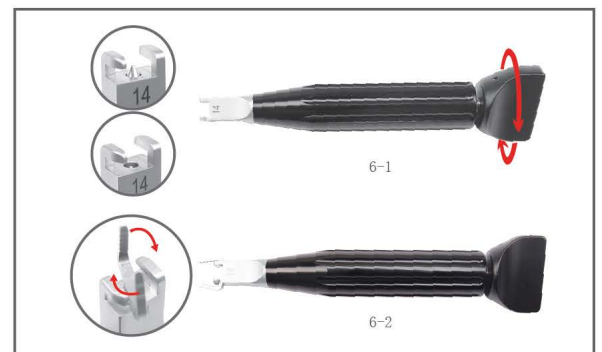

Fig.6

4. Connect the spreader

Connect the selected product to the spreader of the corresponding size.

① Rotate the tail knob of the spreader counterclockwise until the tip is below the spreader connection platform (refer to Fig. 6-1).

② Install the product on the spreader as shown in Fig. 6-2.

Sawtooth-Arm Embracing Fixator

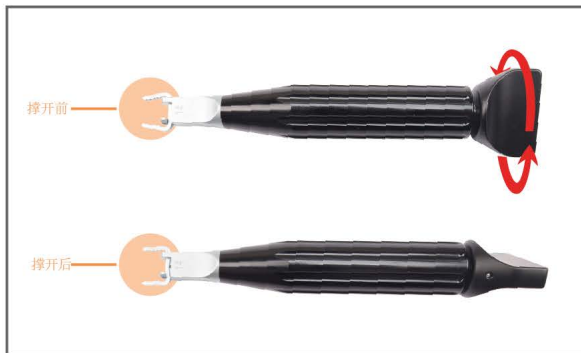

Fig.7

5. Spread

Rotate the tail knob of the spreader clockwise to expand the product until legs A and B are parallel.



Fig.8

6. Insert

Remove the positioning rod, then insert the spread product into the pre-drilled hole, positioning it as close to the cortical bone as possible.



Fig.9

7. Remove the spreader

① First, rotate the tail knob of the spreader counterclockwise until fully loosened (refer to Figure 9-①).

② Rotate the spreader counterclockwise to remove it (refer to Figure 9-②).



Fig.10

8. Drive in

Use the inserter along with a bone mallet to drive the product into the bone surface.



Fig.11

9. Surgical operation completed



Distributor: SUZHOU KANGLI ORTHOPAEDICS
INSTRUMENT CO.,LTD.
Manufacturer: b-ONE New THYTEC SHANGHAI
Medtech CO.,LTD.
TEL: +86 512-58358992 +86 512-58358993
FAX: +86 512-58561012
SITE: www.kangliortho.com
Email: support@kangliortho.com